

Plan Section - Block Course 1 & 3

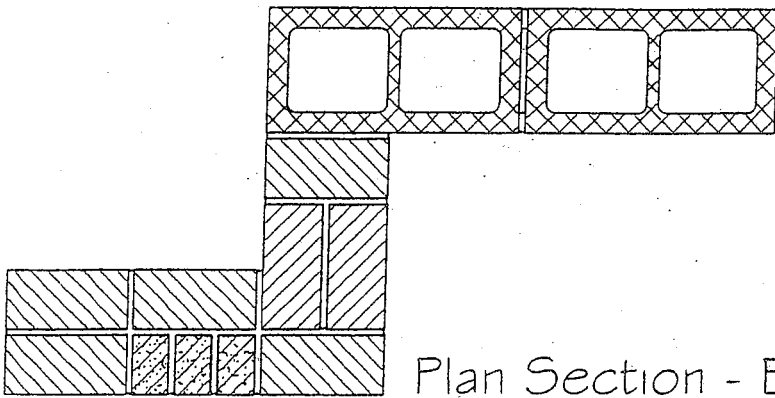

Plan Section - Block Course 2

- Flush accent soldier panel
- Materials:
- 2 - 8" CMU Cap
  - 2 - Half 8" CMU
  - 10 ● - 8" CMU
  - 2 - Uncored Modular Brick - Type A
  - 3 - Modular Brick - Type B
  - 67 - Modular Brick - Type A

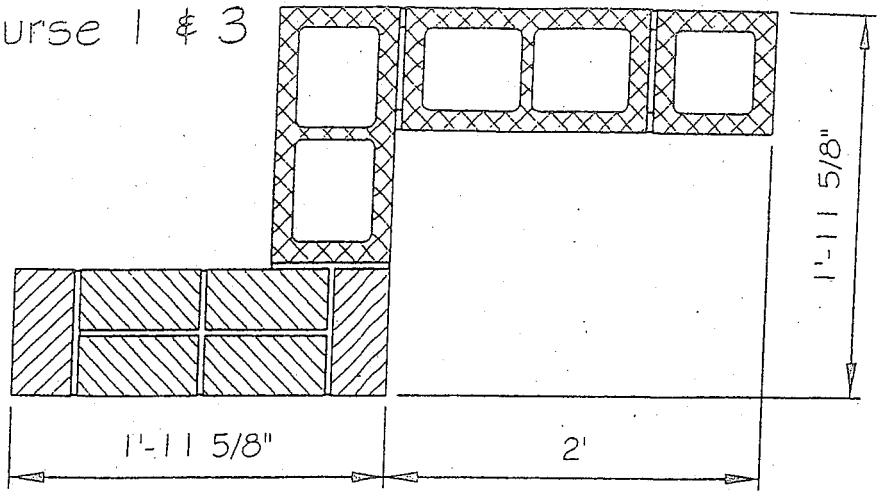
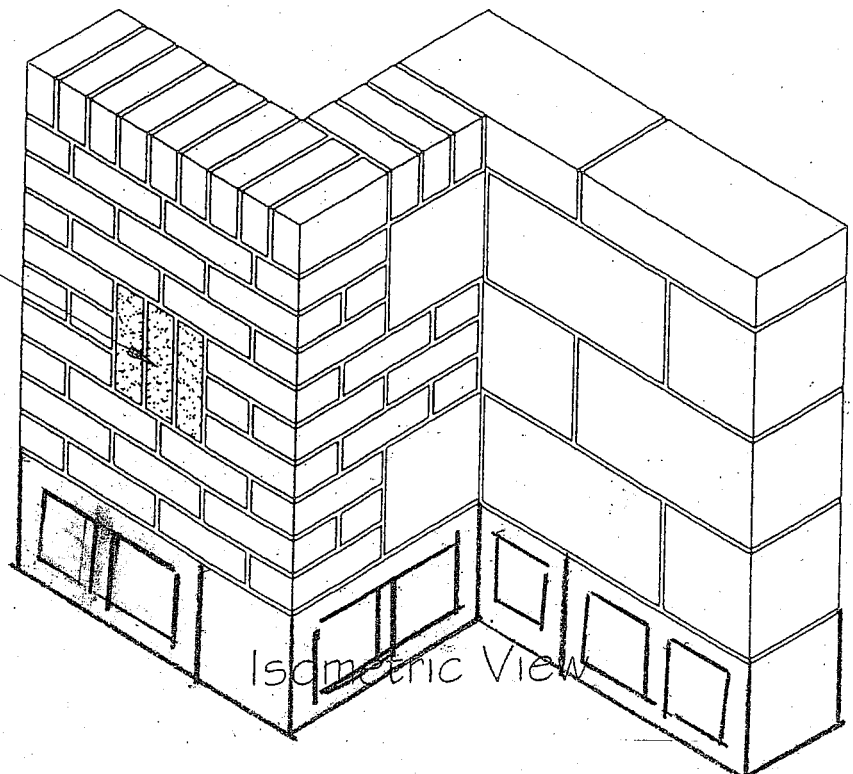

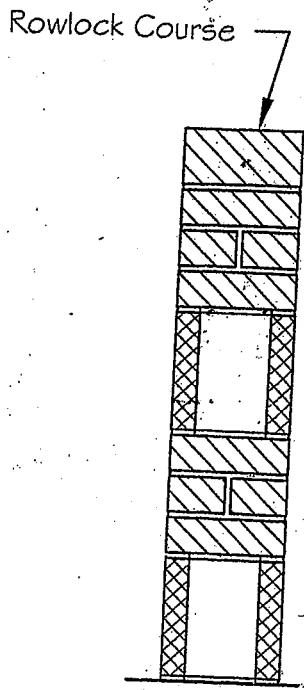

Section

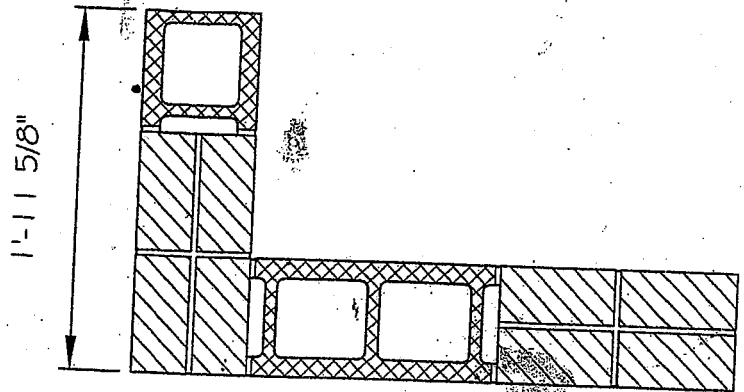

Plan Section

Materials:

- 4 - Half 8" CMU
- 7 - 8" CMU
- 78 - Modular Brick
- 3 - Uncored Modular

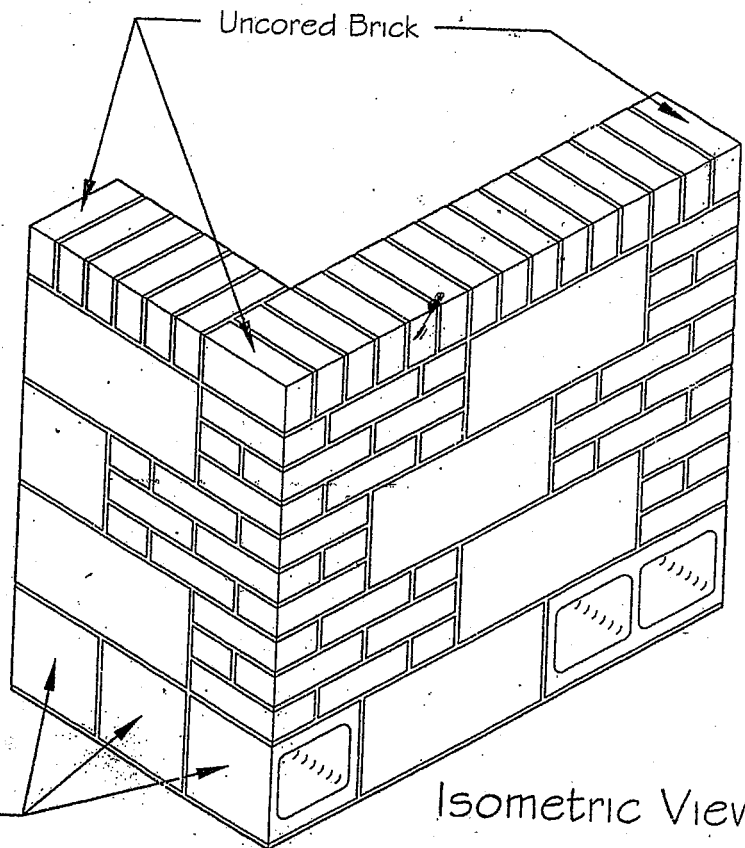

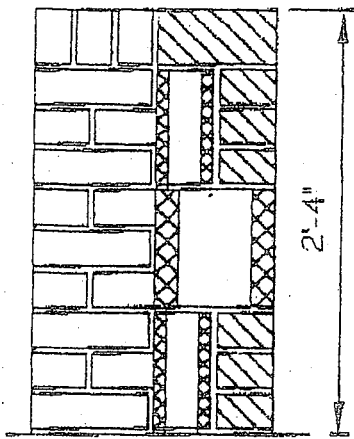

Section

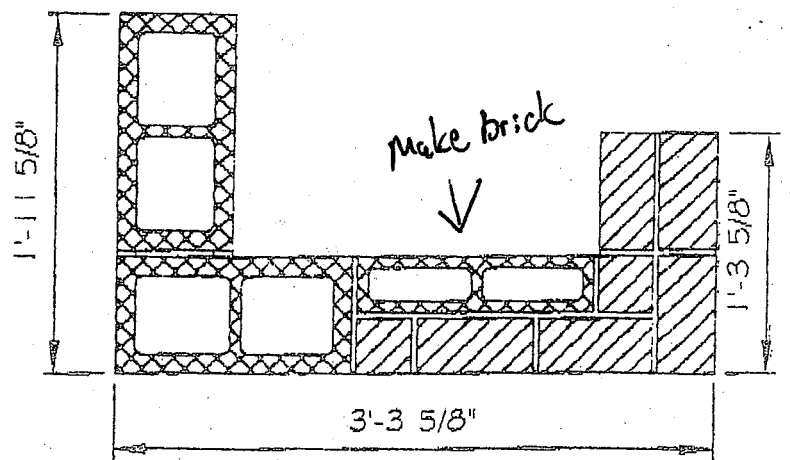

Plan Sect. at Starter Course

Materials:

- 9 ● - 8" CMU
- 1 - Half 8" CMU
- 2 - 4" CMU
- 1 - Half 4" CMU
- 71 - Modular Brick
- 4 - Uncored Modular Brick

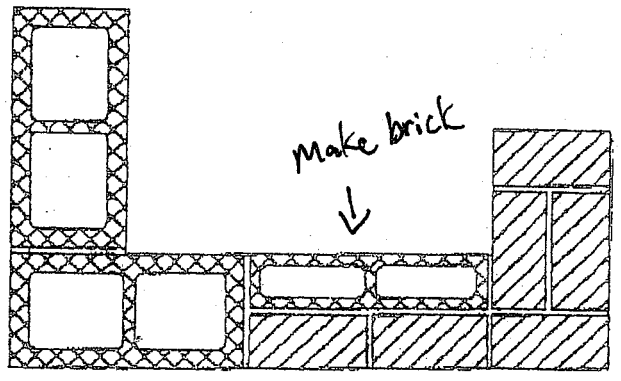

Plan Sect. at 2nd Brick Course

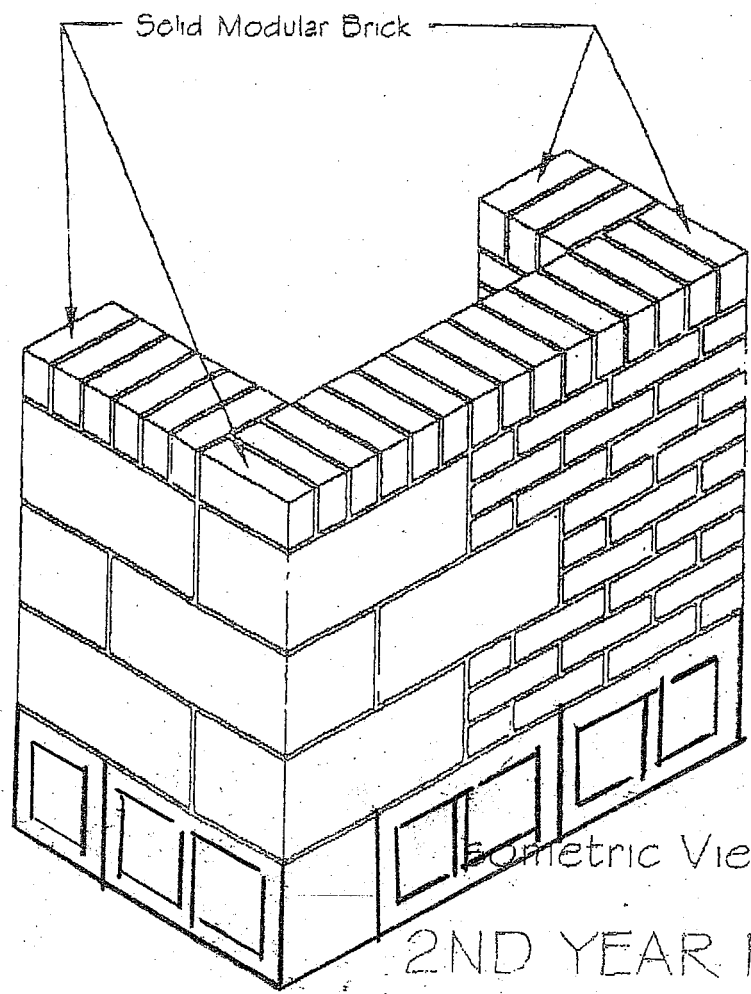

Isometric View

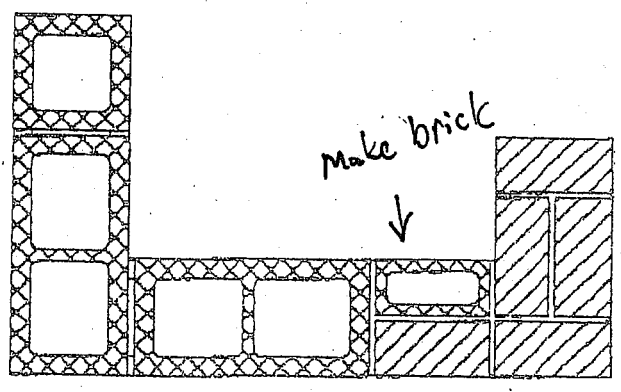

Plan Sect. at 2nd Block Course